

Aerial Map

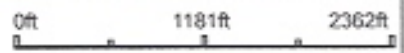

map center: 45° 14' 50.9, -97° 12' 2.55



20-121N-52W
Grant County
South Dakota



5/29/2019



© AgriData, Inc. 2019 www.AgriData.com
Field borders provided by Farm Service Agency as of 5/21/2008.

Soils Map

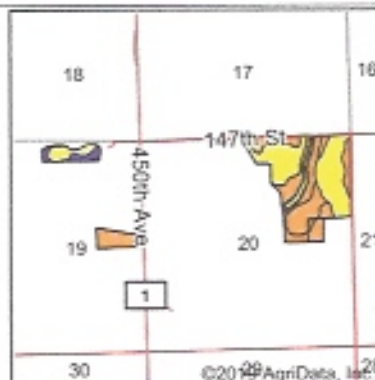
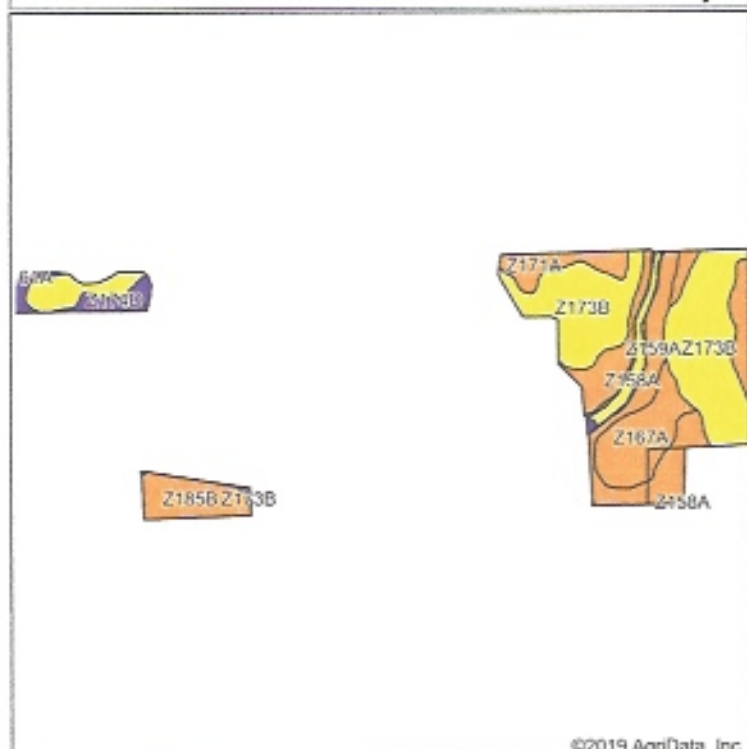

State: **South Dakota**
 County: **Grant**
 Location: **20-121N-52W**
 Township: **Blooming Valley**
 Acres: **136.57**
 Date: **5/29/2019**

©2019 AgriData, Inc.

Maps Provided By



© AgriData, Inc. 2019

www.AgrDataInc.com

Soils data provided by USDA and NRCS.

Area Symbol: SD051, Soil Area Version: 20

Code	Soil Description	Acres	Percent of field	Non-Irr Class Legend	Non-Irr Class *c	Productivity Index	*n NCCPI Soybeans
Z173B	Renshaw-Sioux complex, coteau, 2 to 6 percent slopes	58.88	43.1%		IVs	34	27
Z159A	Divide loam, 0 to 2 percent slopes, occasionally flooded	27.45	20.1%		IIIIs	54	27
Z167A	Renwash loam, 0 to 2 percent slopes, rarely flooded	15.26	11.2%		IIIIs	47	19
Z171A	Renshaw-Fordville loams, coteau, 0 to 2 percent slopes	13.67	10.0%		IIIIs	47	37
Z185B	Egeland-Embsden complex, coteau, 2 to 6 percent slopes	10.16	7.4%		IIIe	54	40
Z174D	Sioux-Renshaw complex, coteau, 9 to 15 percent slopes	5.23	3.8%		VIIs	21	23
Z158A	Marysland loam, 0 to 1 percent slopes, occasionally flooded	5.09	3.7%		IVw	32	48
Z150A	Rauville silty clay loam, coteau, 0 to 1 percent slopes, frequently flooded	0.63	0.5%		Vw	23	1
Z174F	Sioux-Renshaw complex, coteau, 15 to 40 percent slopes	0.20	0.1%		VIIe	14	9
Weighted Average						41.6	*n 28.6

*n: The aggregation method is "Weighted Average using major components"

*c: Using Capabilities Class Dominant Condition Aggregation Method

Soils data provided by USDA and NRCS.